

[III type cable assembly]

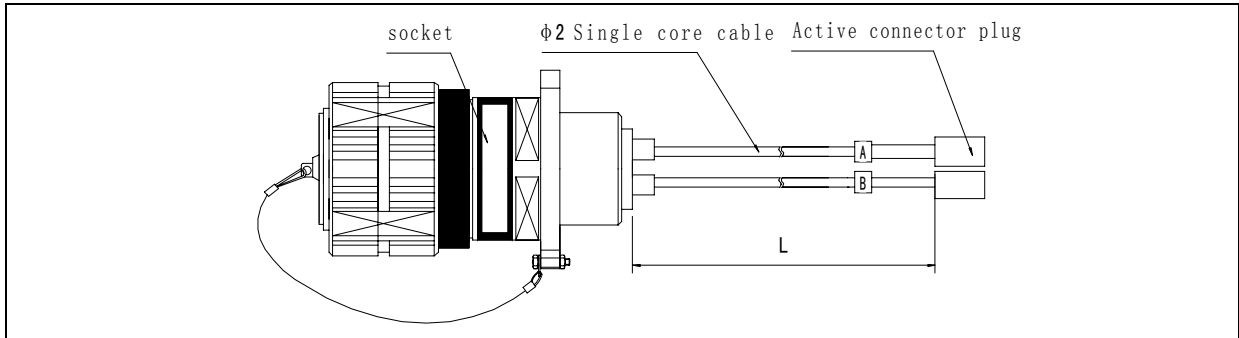

[Ordering information]

1 end plug type	AOH15F02A1D11N03	-2FC	-S	2	-L3
Quantity and type of 2 end plug					
Cable characteristic	S—Single mode G. 652 M—Multiple mode 62.5/125 MI—Multiple mode 50/125				
Diameter of cable	Unit: mm				
Length of cable	According to customer's requirement, unit: m				

[Adapting receptacle AOH15F02C1D11N03]

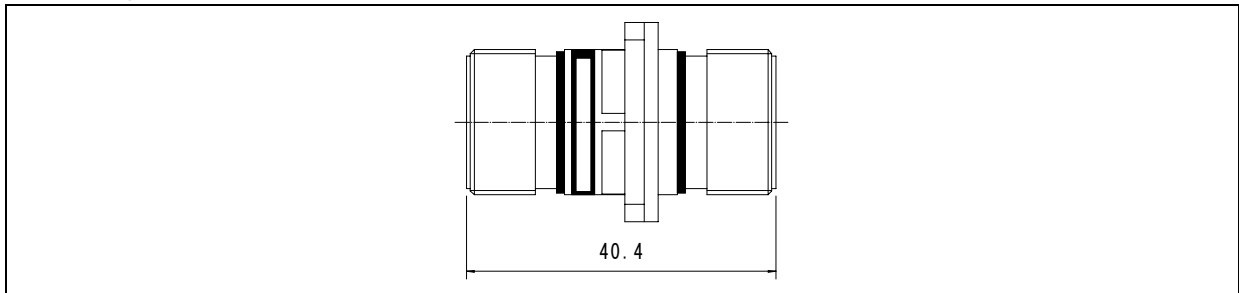

[Ordering information]

1 end plug type	AOH15F02C1D11N03	-S
Quantity and type of 2 end plug	S—Single mode G. 652 M—Multiple mode 62.5/125 MI—Multiple mode 50/125	

- Notes: 1) Copper alloy nickel plating shell or stainless steel passive shell;
 2) Movable plug can be MTRJ/DLC/SC/ASC/FC/AFC/ST/LC and MU, etc;
 3) L and L1 are in accordance with the customer's requirement