

SSMB

SSMB series connectors are the small type push-in RF coaxial connectors manufactured according to IEC60169-19 and CECC22170, with 1/3 space volume of SMB connectors. It has such characteristics as small space volume, light weight, easy to use and good anti-vibration performance. It is used for connecting the coaxial cables in small wireless instruments and telecommunication equipments.

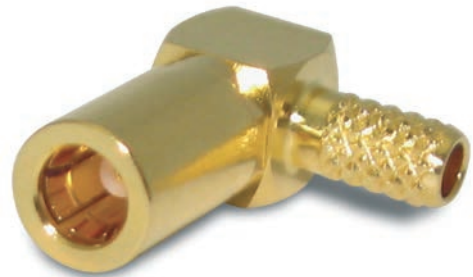

Electric Data		
Characteristic Impedance	50 ohm	
Frequency Range	0~3 GHz	
Working Voltage	250 VRMS(max at sea level)	
Dielectric Withstanding Voltage	500 VRMS(min at sea level)	
VSWR	Straight: ≤1.22 (0-1GHz), ≤1.35 (1-3GHz)	
Contact Resistance	Inner: 5 milliohms(max) Outer: 2.5 milliohms(max)	
Insulation Resistance	1000 megohms(min)	
Mechanical Data		
Durability Mating	500 Cycles min.	
Material Data		
Connector Parts	Materials	Plating Finish
Body	Brass	Gold
Male Pin	Brass	Gold
Insulators	PTFE	N/A
Ferrules	Copper alloy	Nickel or Gold
Environmental Data		
Temperature Range	-55~+155℃	

Note: We can provide other materials and plating specifications according to customers' requirements



APMA

Part Number	Description	Cable Category	Notes
SSMB-JIC-215	SSMB Female Straight Crimp Type	2/50S(SFF-50-1,SYV-50-1,RG-178B/U,196/U)	A=2.5,B=1.6
SSMB-JIC-235		2.6/50S(SFF-50-1.5-1,RG-174/U,188A/U,316/U,LMR-100A)	A=2.8,B=1.6
SSMB-JIC-245		2.6/50D(RG-316DT, RD-316)	A=3.4,B=1.6
SSMB-JIC-315		3/50S(SYV-50-2-1)	A=3.1,B=1.6

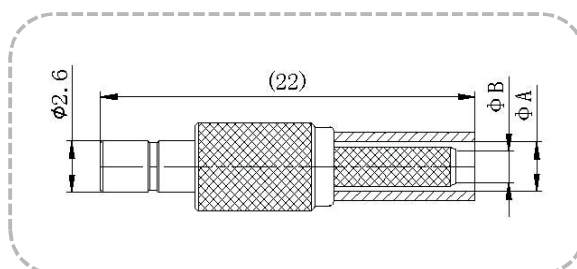
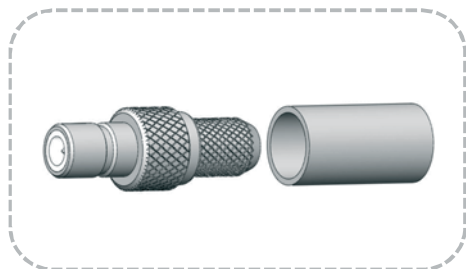

Part Number	Description	Cable Category	Notes
SSMB-JTC-215	SSMB Female Right Angle Crimp Type	2/50S(SFF-50-1,SYV-50-1,RG-178B/U,196/U)	A=2.5,B=1.6
SSMB-JTC-235		2.6/50S(SFF-50-1.5-1,RG-174/U,188A/U,316/U,LMR-100A)	A=2.8,B=1.6
SSMB-JTC-245		2.6/50D(RG-316DT, RD-316)	A=3.4,B=1.6
SSMB-JTC-315		3/50S(SYV-50-2-1)	A=3.1,B=1.6

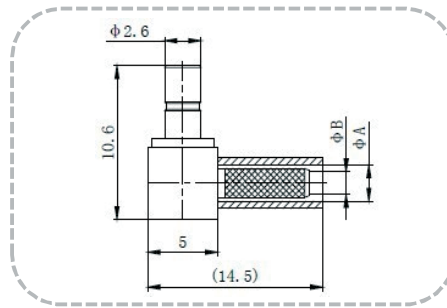
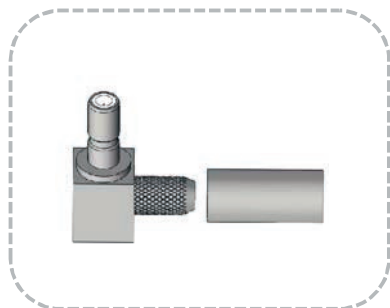

Part Number	Description	Cable Category	Notes
SSMB-JKC-215	SSMB Female Bulkhead Crimp Type	2/50S(SFF-50-1,SYV-50-1,RG-178B/U,196/U)	A=3.1,B=1.0
SSMB-JKC-235		2.6/50S(SFF-50-1.5-1,RG-174/U,188A/U,316/U,LMR-100A)	A=2.8,B=1.6
SSMB-JKC-245		2.6/50D(RG-316DT, RD-316)	A=3.4,B=1.6
SSMB-JKC-315		3/50S(SYV-50-2-1)	A=3.1,B=1.6

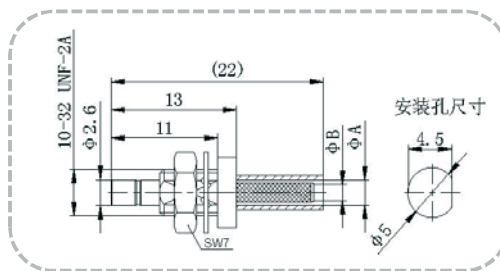
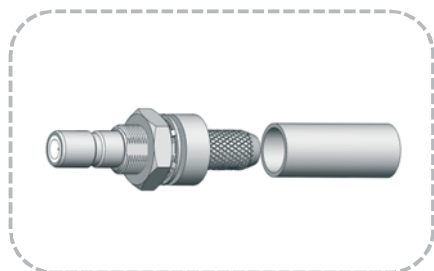



APMA

Part Number	Description	Cable Category	Notes
SSMB-PIC-215		2/50S(SFF-50-1,SYV-50-1,RG-178B/U,196/U)	A=2.5,B=1.6
SSMB-PIC-235	SSMB Male Straight	2.6/50S(SFF-50-1.5-1,RG-174/U,188A/U,316/U,LMR-100A)	A=2.8,B=1.6
SSMB-PIC-245	Crimp Type	2.6/50D(RG-316DT, RD-316)	A=3.4,B=1.6
SSMB-PIC-315		3/50S(SYV-50-2-1)	A=3.1,B=1.6

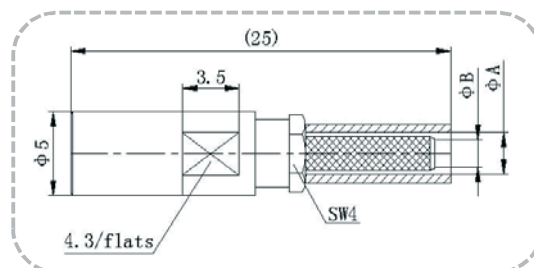
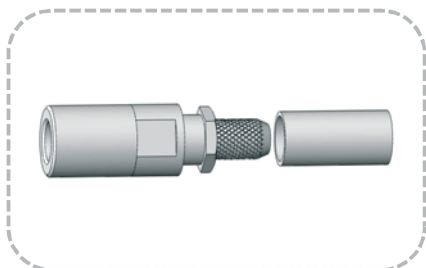

Part Number	Description	Cable Category	Notes
SSMB-PTC-215		2/50S(SFF-50-1,SYV-50-1,RG-178B/U,196/U)	A=2.5,B=1.6
SSMB-PTC-235	SSMB Male Right Angle	2.6/50S(SFF-50-1.5-1,RG-174/U,188A/U,316/U,LMR-100A)	A=2.8,B=1.6
SSMB-PTC-245	Crimp Type	2.6/50D(RG-316DT, RD-316)	A=3.4,B=1.6
SSMB-PTC-315		3/50S(SYV-50-2-1)	A=3.1,B=1.6

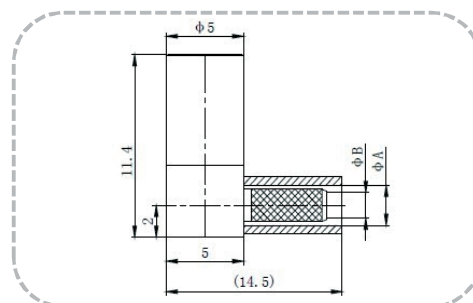
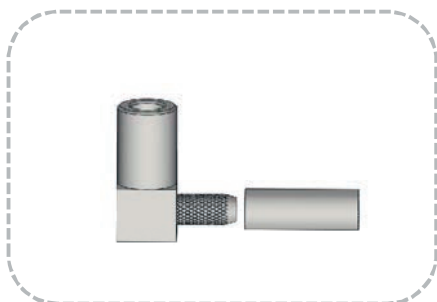

Part Number	Description
-------------	-------------

SSMB-PIB

SSMB Male Straight PCB Mount Type

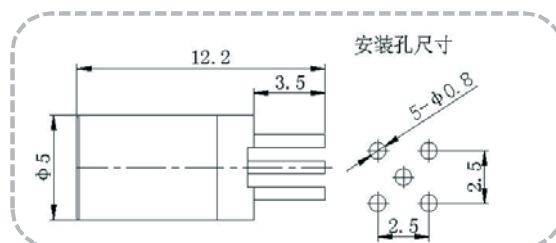
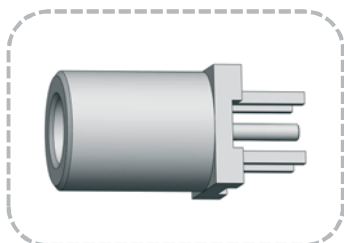

Part Number	Description
-------------	-------------

SSMB-JIB-01

SSMB Female Straight PCB Mount Type

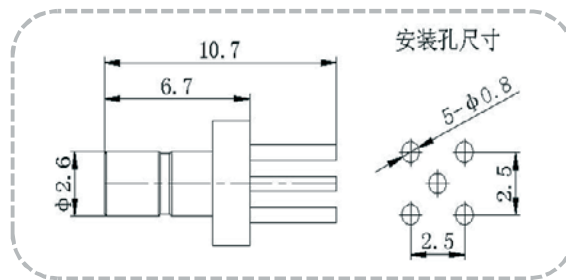
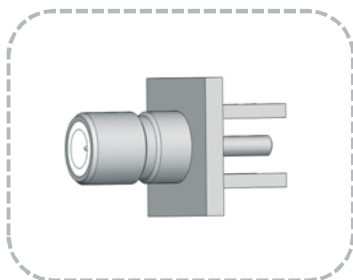

Part Number	Description
-------------	-------------

SSMB-JIB-02

SSMB Female Straight PCB Mount Type

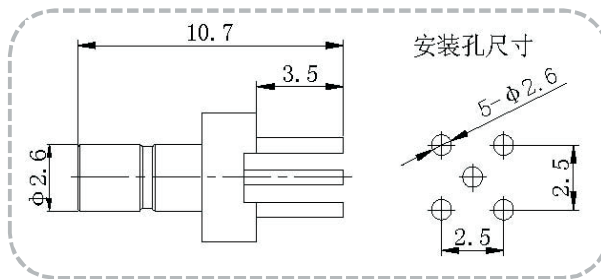
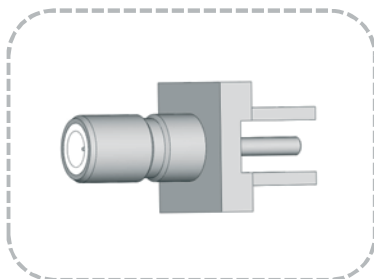

Part Number	Description
-------------	-------------

SSMB-JTB

SSMB Female Right Angle PCB mount type

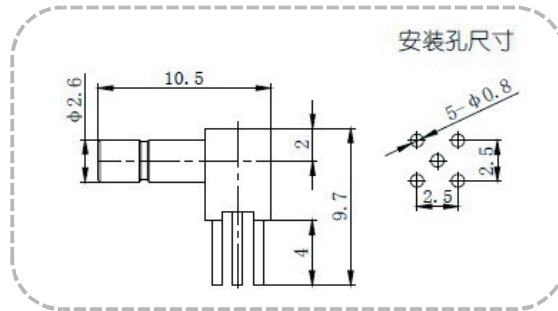
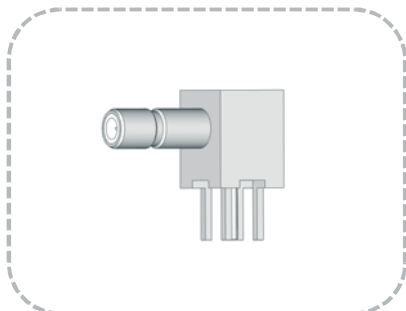

Part Number	Description
-------------	-------------

SSMB-JIE

SSMB Female Straight End Launch Receptacle

