

SMC

SMC series connectors are the small thread-type RF coaxial connectors manufactured according to MIL-C-39012, IEC169-9 and CECC22140. It has such characteristics as small space volume, light weight, good anti-vibration performance, high reliability, etc. It is used for connecting the coaxial cables in wireless equipments and telecommunication equipments.



Electric Data		
Characteristic Impedance	50ohm	
Frequency Range	0-10GHz	
Working Voltage	250 VRMS(max at sea level)	
Dielectric Withstanding Voltage	750 VRMS(min at sea level)	
VSWR	Straight: 1.25 max	
Contact Resistance	Inner: 6 milliohms(max)	
	Outer: 1 milliohms(max)	
Insulation Resistance	1000 megohms(min)	
Mechanical Data		
Durability Mating	500 Cycles min.	
Material Data		
Connector Parts	Materials	Plating Finish
Body	Brass	Gold
Male Pin	Brass	Gold
Insulators	PTFE	N/A
Ferrules	Copper alloy	Nickel
Environmental Data		
Temperature Range	-65~+165℃	

Note: We can provide other materials and plating specifications according to customers' requirements



APMA

Part Number	Description	Cable Category	Notes
SMC-JTS-001	SMC Female R/A Solder For Semi-	085(SFT-50-2-1, SM86, RG-405/U)	A=2.2, B=3.0
SMC-JTS-002	Rigid Cable	141(SFT-50-3-1, SM141, RG-402/U)	A=3.6, B=4.6

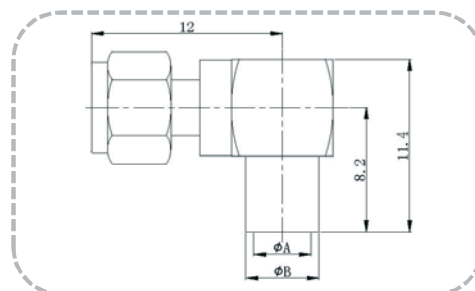
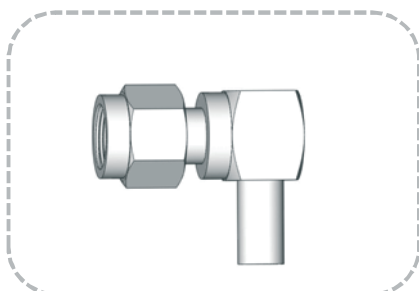

Part Number	Description	Cable Category	Notes
SMC-JTC-215	SMC Female R/A Crimp Type	2/50S(SFF-50-1, SYV-50-1, RG-178B/U, 196/U)	A=2.5, B=1.0
SMC-JTC-235		2.6/50S(SFF-50-1.5-1, RG-174/U, 188A/U, 316/U, LMR-100A)	A=2.8, B=1.6
SMC-JTC-315		3/50S(SYV-50-2-1)	A=3.1, B=1.6

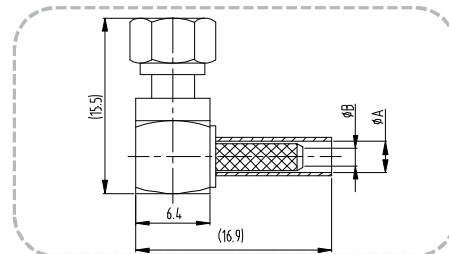
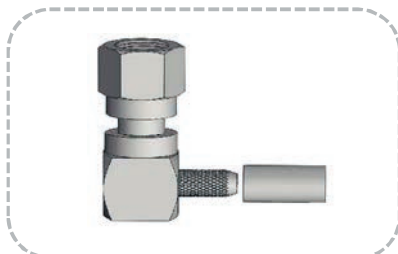

Part Number	Description	Cable Category	Notes
SMC-JIC-215	SMC Female Straight Crimp Type	2/50S(SFF-50-1, SYV-50-1, RG-178B/U, 196/U)	A=2.5, B=1.0
SMC-JIC-235		2.6/50S(SFF-50-1.5-1, RG-174/U, 188A/U, 316/U, LMR-100A)	A=2.8, B=1.6
SMC-JIC-315		3/50S(SYV-50-2-1)	A=3.1, B=1.6

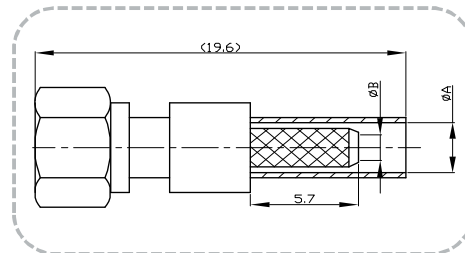
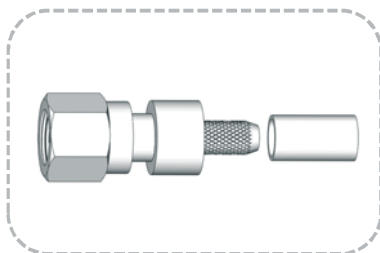

Part Number	Description	Cable Category	Notes
SMC-PKC-215	SMC Male Straight Bulkhead Crimp Type	2/50S(SFF-50-1, SYV-50-1, RG-178B/U, 196/U)	A=2.5, B=1.0
SMC-PKC-235		2.6/50S(SFF-50-1.5-1, RG-174/U, 188A/U, 316/U, LMR-100A)	A=2.8, B=1.6
SMC-PKC-315		3/50S(SYV-50-2-1)	A=3.1, B=1.6

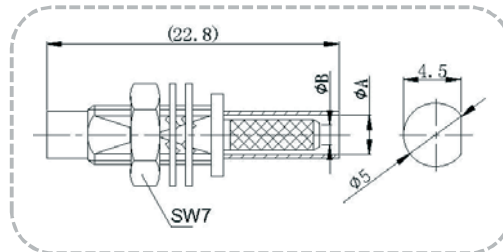
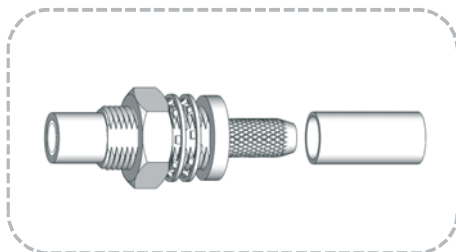

Technical drawing of a bolt and nut assembly. The bolt has a total length of 15 and a threaded section length of 2. The nut has a height of 1.7. The drawing is labeled with 'SW7' pointing to the bolt head.

SMC-PTC-215		2/50S(SFF-50-1,SYV-50-1,RG-178B/U,196/U)	A=2.5,B=1.0
SMC-PTC-235	SMC Male R/A Crimp Type	2.6/50S(SFF-50-1.5-1,RG-174/U,188A/U,316/U,LMR-100A)	A=2.8,B=1.6
SMC-PTC-315		3/50S(SYV-50-2-1)	A=3.1,B=1.6

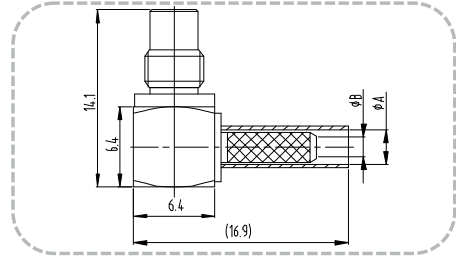

SMC-JIS-001	SMC Female Straight Solder	085(SFT-50-2-1,SM86,RG-405/U)	A=2.2,B=3.0
SMC-JIS-002	For Semi-Rigid Cable	141(SFT-50-3-1,SM141,RG-402/U)	A=3.6,B=4.6

