

C4

C4(DIN 41626) series connectors are small push-in connection coaxial connectors made according to DIN41626. It has such characteristics as small dimensions and reliable mechanical and electrical performance. It is used for connecting RF cables in the high frequency loop of RF telecommunication equipments with PCB high and low frequency connectors.



Electric Data		
Characteristic Impedance	50ohm	
Frequency Range	0-2GHz(50ohm)	
Working Voltage	250 VRMS(max at sea level)	
Dielectric Withstanding Voltage	750 VRMS(min at sea level)	
Contact Resistance	Inner: 10 milliohms(max) Outer: 5 milliohms(max)	
Insulation Resistance	1000 megohms(min)	
Mechanical Data		
Durability Mating	500 Cycles min.	
Material Data		
Connector Parts	Materials	Plating Finish
Body	Brass	Gold
Male Pin	Brass	Gold
Insulators	PTFE	N/A
Ferrules	Copper alloy	Nickel
Spring Contact	Beryllium Bronze	Gold
Environmental Data		
Temperature Range	-55~+125℃	

Note: We can provide other materials and plating specifications according to customers' requirements



APMA

Part Number	Description	Cable Category	Notes
C4-PIC-235		2.6/50S(SFF-50-1.5-1,RG-174/U,188A/U,316/U,LMR-100A)	A=2.8,B=1.6
C4-PIC-245	C4 50ohm Male Straight Crimp type	2.6/50D(RG-316DT,RD-316)	A=3.4,B=1.6
C4-PIC-315		3/50S(SYV-50-2-1)	A=3.1,B=1.6
C4-PIC-325		3/50D(SFF-50-1.5-2)	A=3.5,B=1.6

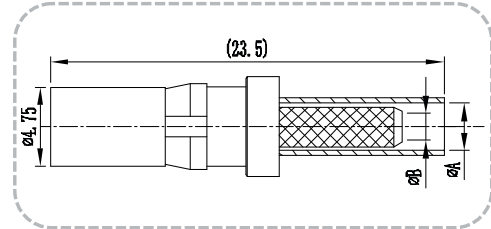
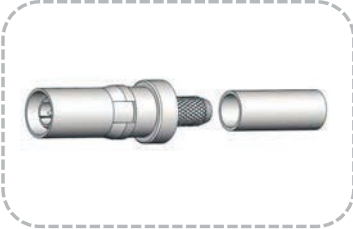

Part Number	Description	Cable Category	Notes
C4-PIC-23501		2.6/50S(SFF-50-1.5-1,RG-174/U,188A/U,316/U,LMR-100A)	A=2.8,B=1.6
C4-PIC-24501	C4 50ohm Male Straight Crimp Type With Solder Window	2.6/50D(RG-316DT,RD-316)	A=3.4,B=1.6
C4-PIC-31501		3/50S(SYV-50-2-1)	A=3.1,B=1.6
C4-PIC-32501		3/50D(SFF-50-1.5-2)	A=3.5,B=1.6

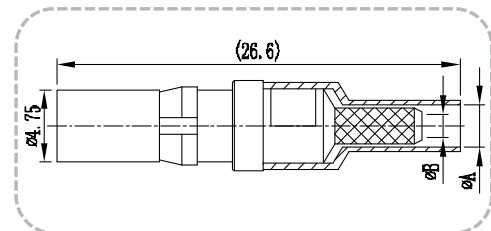
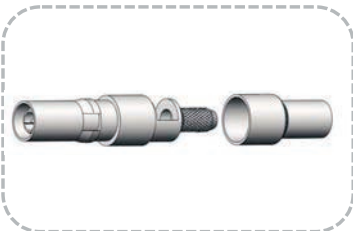

Part Number	Description	Cable Category	Notes
C4-PTC-235		2.6/50S(SFF-50-1.5-1,RG-174/U,188A/U,316/U,LMR-100A)	A=2.8,B=1.6
C4-PTC-245	C4 50ohm Male R/A Crimp Type	2.6/50D(RG-316DT,RD-316)	A=3.4,B=1.6
C4-PTC-315		3/50S(SYV-50-2-1)	A=3.1,B=1.6

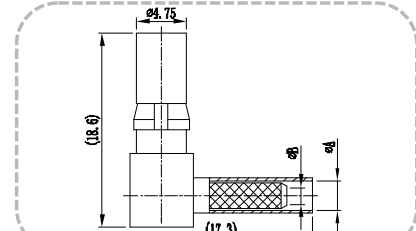
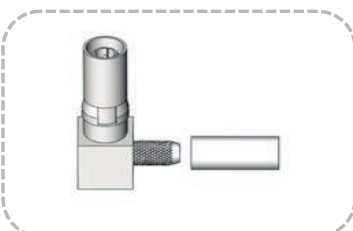



APMA

Part Number	Description	Cable Category	Notes
C4-JIC-235		2.6/50S(SFF-50-1.5-1,RG-174/U,188A/U,316/U,LMR-100A)	A=2.8,B=1.6
C4-JIC-245	C4 50ohm Female Straight Crimp type	2.6/50D(RG-316DT,RD-316)	A=3.4,B=1.6
C4-JIC-315		3/50S(SYV-50-2-1)	A=3.1,B=1.6

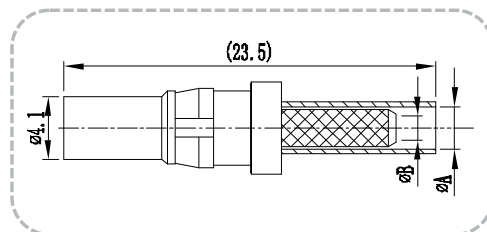
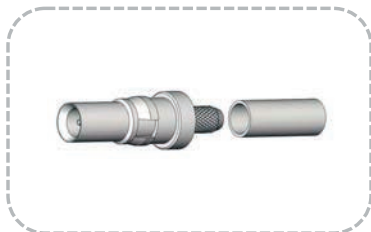

Part Number	Description	Cable Category	Notes
C4-JIC-23501		2.6/50S(SFF-50-1.5-1,RG-174/U,188A/U,316/U,LMR-100A)	A=2.8,B=1.6
C4-JIC-24501	C4 50ohm Female Straight Crimp Type With Solder Window	2.6/50D(RG-316DT,RD-316)	A=3.4,B=1.6
C4-JIC-31501		3/50S(SYV-50-2-1)	A=3.1,B=1.6
C4-JIC-32501		3/50D(SFF-50-1.5-2)	A=3.4,B=1.6

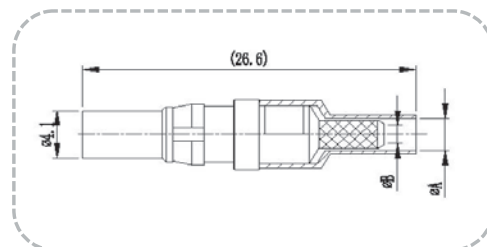
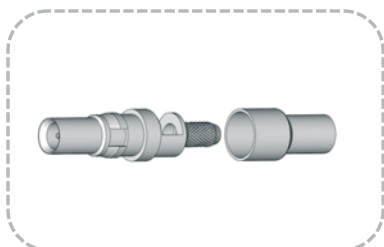

Part Number	Description	Cable Category	Notes
C4-JTC-235		2.6/50S(SFF-50-1.5-1,RG-174/U,188A/U,316/U,LMR-100A)	A=2.5,B=1.0
C4-JTC-245	C4 50ohm Female R/A Crimp Type	2.6/50D(RG-316DT,RD-316)	A=2.8,B=1.6
C4-JTC-315		3/50S(SYV-50-2-1)	A=3.4,B=1.6
C4-JTC-325		3/50D(SFF-50-1.5-2)	A=3.1,B=1.6

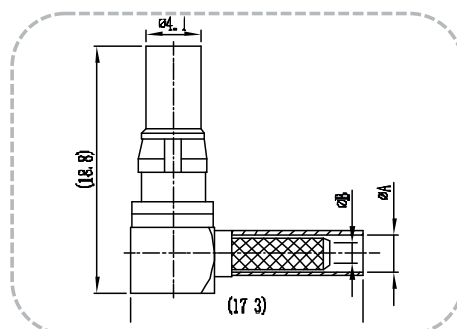
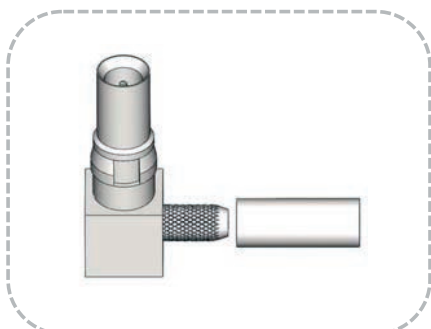

C4-JIC-237	C4 75ohm Female Straight Crimp Type With Solder Window	2.6/75S(SFF-75-1.5-1,RG179B/U,187/U,1.5C-2V,Flex1.5,Flex2)	A=2.8,B=1.6
C4-JIC-317		3/75S(SYV-75-2,RA8000)	A=3.1,B=1.6

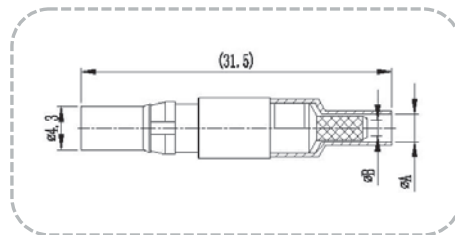

Part Number	Description
-------------	-------------

C4 50ohm Male Straight PCB Mount
Type

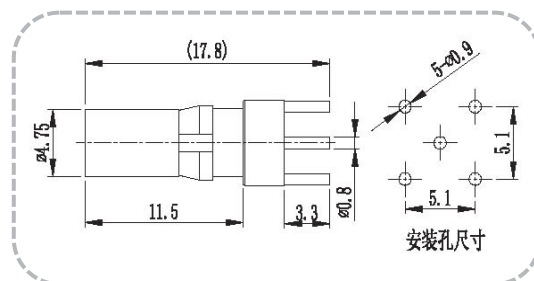

Part Number	Description
-------------	-------------

C4 75ohm Male R/A PCB Mount Type

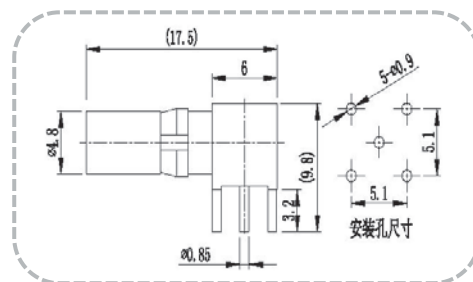

C4-PIC-217	C4 75ohm Male Straight	2/75S(SFF-75-1)	A=2.8,B=1.6
C4-PIC-237	Crimp Type With Solder	2.6/75S(SFF-75-1.5-1,RG179B/U,187/U,1.5C-2V,Flex1.5,Flex2)	A=3.4,B=1.6
C4-PIC-317	Window	3/75S(SYV-75-2,RA8000)	A=3.1,B=1.6

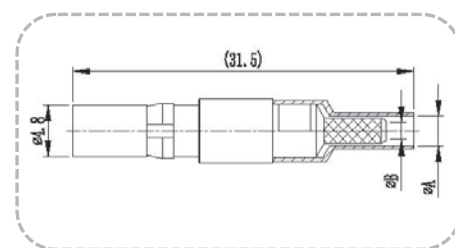

Part Number	Description
-------------	-------------

C4-PTB-01

C4 50ohm Male R/A PCB Mount Type

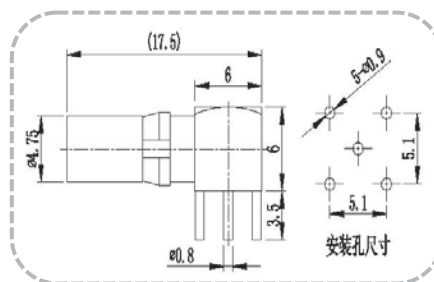
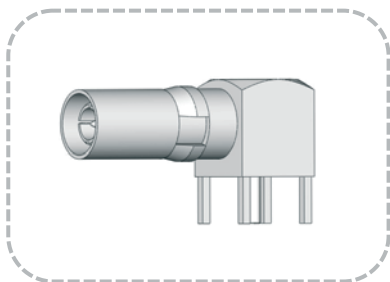

Part Number	Description
-------------	-------------

C4-JIB

C4 50ohm Female Straight PCB Mount Type

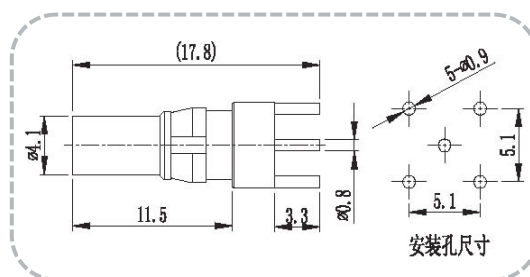
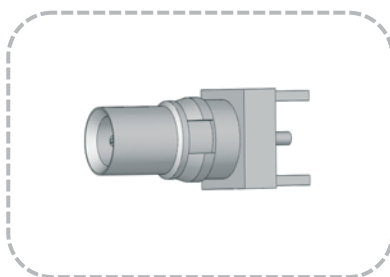

Part Number	Description
-------------	-------------

C4-JTB-01

C4 50ohm Female R/A PCB Mount Type

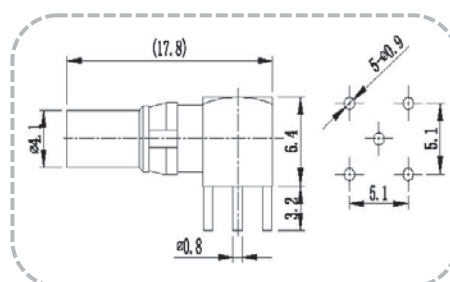
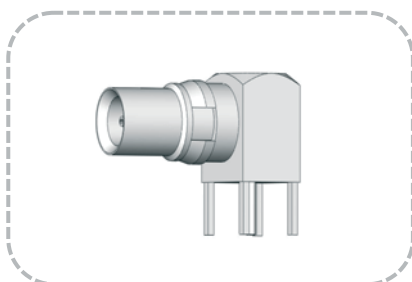

Part Number	Description
-------------	-------------

C4-JTB-02

C4 75ohm Female R/A PCB Mount Type

