

ОНЦ-БС-1(2) Type electrical connectors are used in DC and AC circuits. The plug and socket are bayonet connection.

Plug without tail attached to smoke socket with straight plastic tail attached.

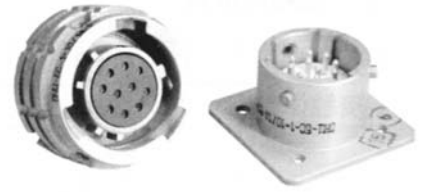

Localized model: **ОНС-БС**



Technical performance

- ⊙ Contact resistance: $\leq 5\text{m}\Omega$
- ⊙ Insulation resistance: $\geq 1000\text{M}\Omega$ (Under normal conditions)
- ⊙ Operation temperature: $-60^\circ\text{C} \sim 85^\circ\text{C}$
- ⊙ Working current, operating voltage:
- ⊙ Vibration: 1–5000Hz 20g
- ⊙ Shock: once 1000g, multiple times 100g
- ⊙ Contact diameter: $\varnothing 1.0\text{mm}$

Shell number	Number of contacts	Single contact Working current (A)	Sum of current (A)	Operating Voltage (V)
10	4	3.7	15	250
12	7	3.1	22	250
14	10	3.0	30	250
18	19	2.1	40	250
22	32	1.8	60	250
27	50	1.5	75	250

Mechanical life: 250 cycles, Operating hours: 5000 hour
 Guarantee period: 15 years, Technical conditions: БПО.364.030TV

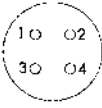
Insulator arrangement

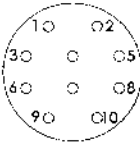
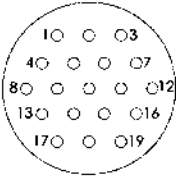
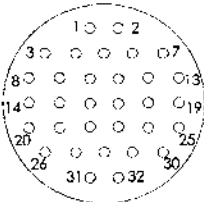
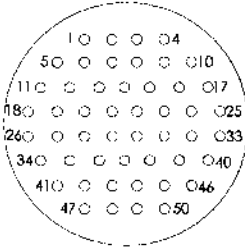
Shell number	10	12	14	18
No. of contacts	4	7	10	19
Arrangement				
Shell number	22	27		
No. of contacts	32	50		
Arrangement				

Marking description

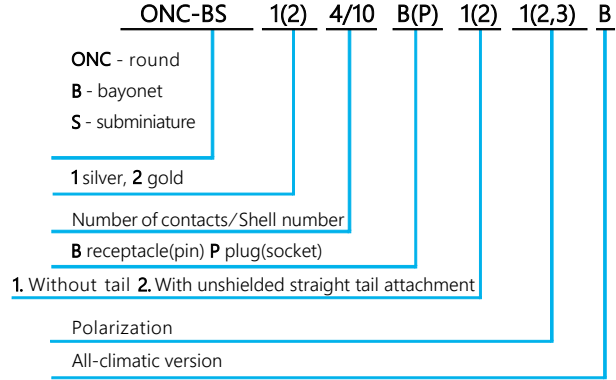
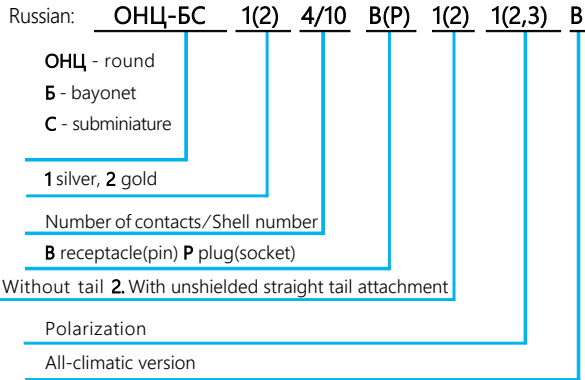

Shape and installation dimensions:

Receptacle without tail attached (pin)

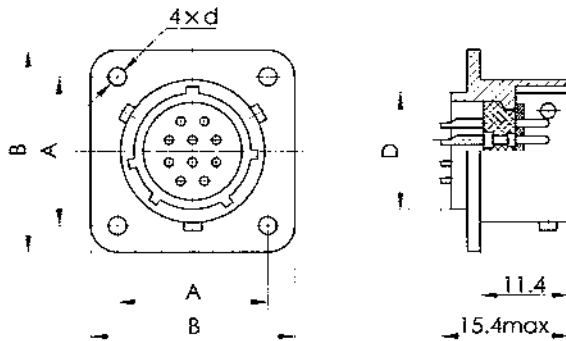

Plug with tail attached (socket)

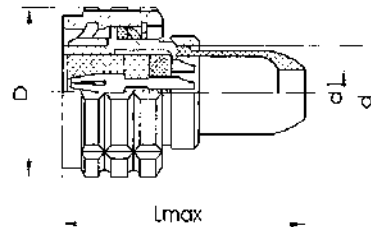

Shell number	Dimensions mm				
	D	d	A	B	b
10	10	2.2	11.8	20	1.4
12	12	2.2	13.2	21	1.4
14	14	2.2	15	24	1.4
18	18	2.2	18	27	1.4
22	22	2.7	21.5	31	1.8
27	27	3.2	26	36	2

Shell number	Dimensions mm			
	D	d	d 1	Lmax
10	20	M10x0.75	4.5	30
12	21	M12x0.75	6	31
14	24	M14x0.75	7	32
18	27	M18x0.75	9.2	33
22	31	M22x0.75	11	34
27	36	M27x0.75	13	36